

## Your booking – essential information

### Investigate for Secondary Schools (KS2)

**Meeting point** When you arrive go to the **School Reception**, Green Zone, Lower Ground Floor, to check in.  
Your activity meeting point is the **Investigate Centre**, please arrive here **five minutes** before your session is due to start. See map overleaf for details.

**Contact** **Pre-visit:** If you have any queries regarding your visit contact Schools Booking on **+44 (0)20 7942 5555**.  
**On the day:** If you think you may arrive late, please call the Learning Engagement Manager on **+44 (0)7887 995953**.

**Preparation** Central London and South Kensington tube station can be very busy so please ensure you leave plenty of time to get to the Museum. Additionally, the Museum often has long entry queues. Missing the start of your session may lead to your session being cancelled.  
Before your visit be sure to read and understand our payment and cancellation conditions: **[www.nhm.ac.uk/school-payment-cancellations](http://www.nhm.ac.uk/school-payment-cancellations)**  
For more information on school group visits to the Museum visit: **[www.nhm.ac.uk/schools-essential-info](http://www.nhm.ac.uk/schools-essential-info)**

**Duration** **50 minutes**

**Ratios** For health and safety purposes, please ensure you have the following ratio of adults to children:  
1 adult : 8 students  
40 students maximum

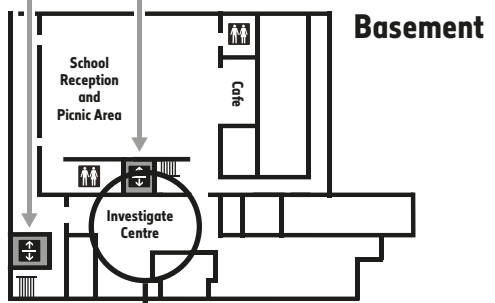
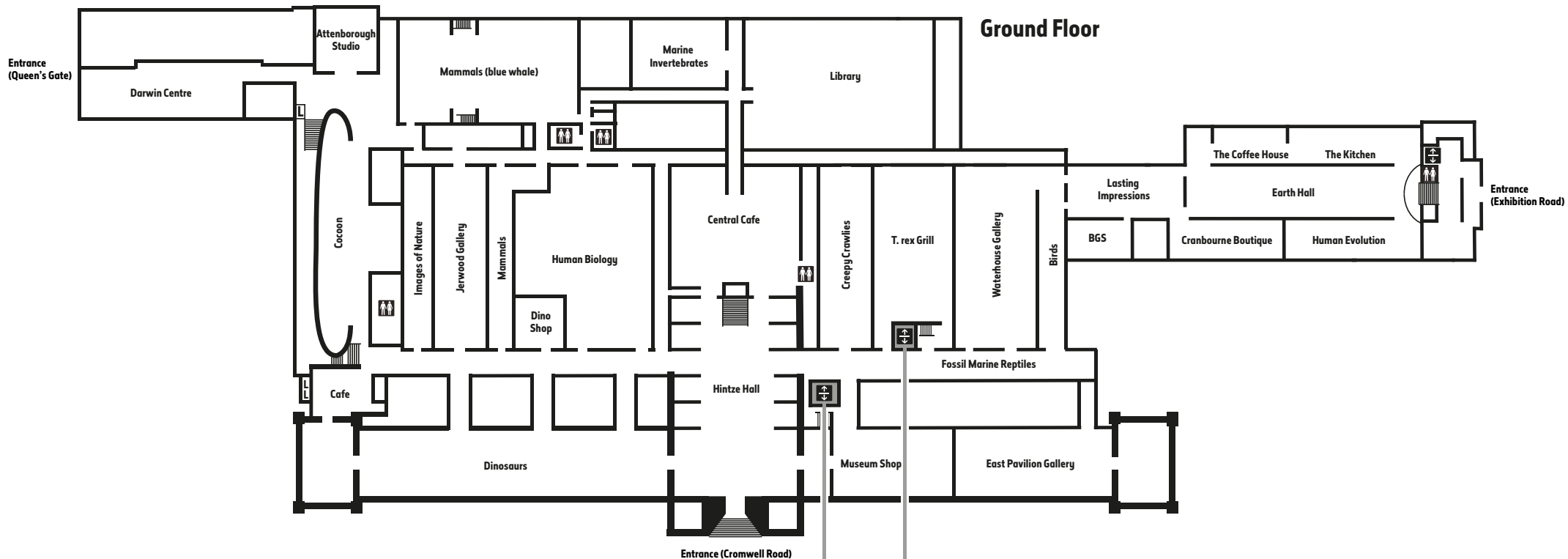

Activity meeting point for  
**Investigate for Schools  
(KS2)**

## Your booking: additional information

### Investigate for Schools (KS2)

#### Overview

Designed to engage ages 7-14 with the science curriculum, the **Investigate Centre** provides pupils with a range of tools to enable them to become scientists for the day – looking for evidence and making discoveries about the natural world. Our enthusiastic science educators are on hand to guide your pupils if they need help finding or using the scientific tools provided.

#### Resources

All resources are provided.

Please note, the **Investigate Centre** is a collections space and no food or drink is allowed during the session.

#### Curriculum links

The activity content falls within the following statements, but does not necessarily support the breadth of content to which the statement refers.

#### KS2: Science

##### Working scientifically

- ask relevant questions and use different types of scientific enquiries to answer them
- make systematic and careful observations and, where appropriate, take accurate measurements using standard units, use a range of equipment
- gather, record, classify and present data in a variety of ways to help answer questions
- report on findings from enquiries, including oral and written explanations, displays or presentations of results and conclusions
- use straightforward scientific evidence to answer questions or to support their findings

##### Year 5 and 6: Working scientifically

- take measurements, using a range of scientific equipment, with increasing accuracy and precision, taking repeat readings when appropriate
- report and present findings from enquiries, including conclusions, causal relationships and explanations of and degree of trust in results, in oral and written forms such as displays and other presentations

##### Year 6: Living things and their habitats

- describe how living things are classified into broad groups according to common observable characteristics and based on similarities and differences, including microorganisms, plants and animals
- give reasons for classifying plants and animals based on specific characteristics