

Your booking – essential information

Storytelling with Puppets

Meeting point When you arrive go to the **School Reception**, Green Zone, Lower Ground Floor, to check in.
Your activity meeting point is the **Marine Invertebrates**, please arrive here **five minutes** before your session is due to start. See map overleaf for details.

Contact **Pre-visit:** If you have any queries regarding your visit contact Schools Booking on **+44 (0)20 7942 5555**.
On the day: If you think you may arrive late, please call the Learning Engagement Manager on **+44 (0)7887 995953**.

Preparation Central London and South Kensington tube station can be very busy so please ensure you leave plenty of time to get to the Museum. Additionally, the Museum often has long entry queues. Missing the start of your session may lead to your session being cancelled.
Before your visit be sure to read and understand our payment and cancellation conditions: **www.nhm.ac.uk/school-payment-cancellations**
For more information on school group visits to the Museum visit: **www.nhm.ac.uk/schools-essential-info**

Duration **30 minutes**

Ratios For health and safety purposes, please ensure you have the following ratios of adults to children:
Nursery groups 1 adult : 5 students (45 students maximum)
Years 1 and 2 groups 1 adult : 8 students (60 students maximum)

Activity meeting point for
Storytelling with Puppets

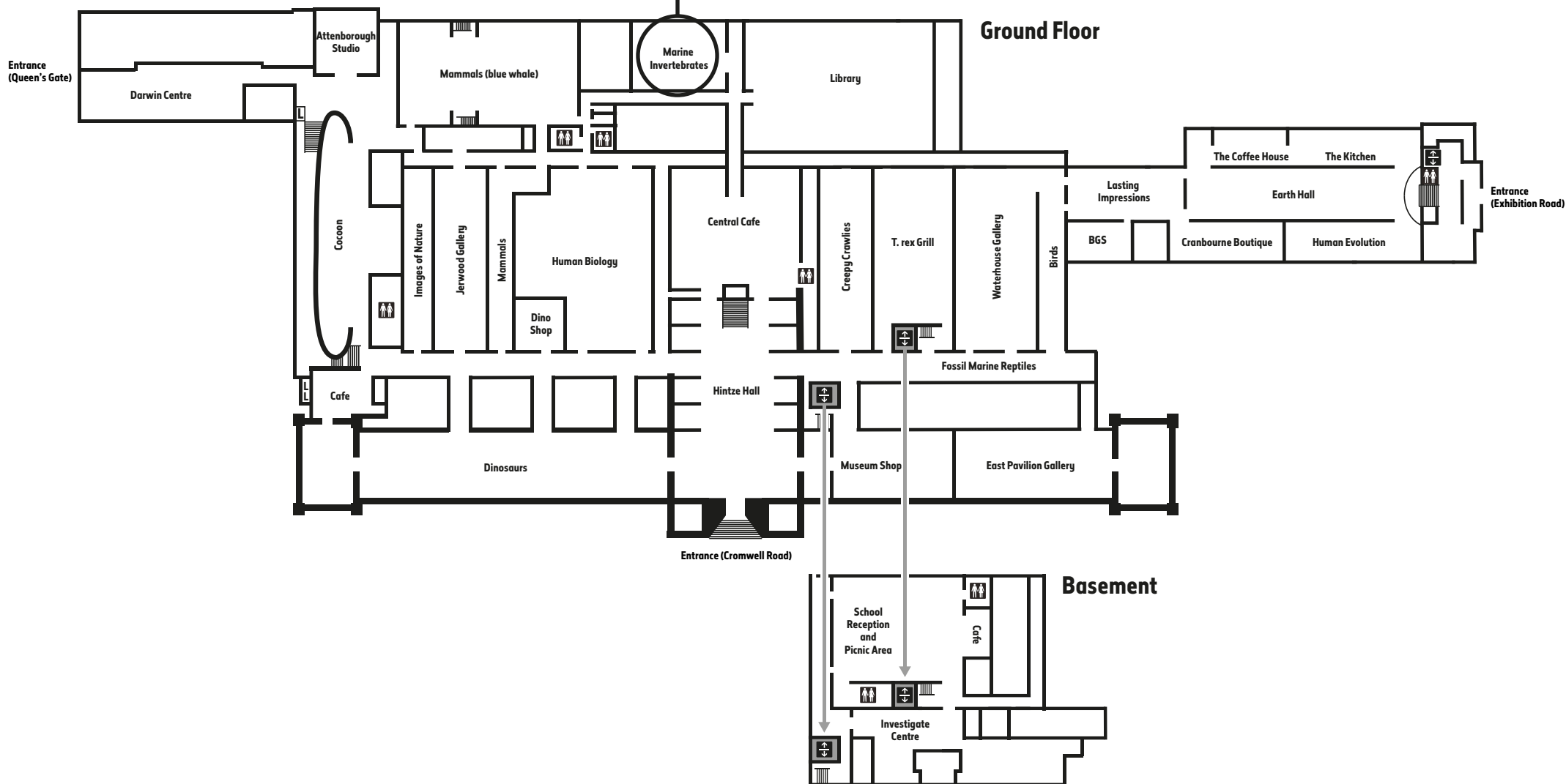

Your booking – additional information

Storytelling with Puppets

Overview

This is an interactive puppet show that uses storytelling to explore natural history and curriculum science in a fun and engaging way. It is suitable for pupils in nursery (3+), reception and KS1. During the show, pupils will be seated on the floor.

There are seven exciting stories for your students to enjoy, please refer to your booking confirmation to see which show you are booking:

- The Little Mermaid and Other Fishy Tales
- The Gingerbread Man and Other Tales
- Wolf Tales
- The Hungry Caterpillar and the Frog Prince
- Jackie and the Beanstalk and Three Billy Goats Gruff
- Little Red Hen and Chicken Little
- Rapunzel and Goldilocks and the Three Bears

Resources

All resources are provided.

Curriculum links

The content of our puppet shows falls within the following statements but will vary depending on which show you book. The shows will not necessarily support the breadth of content to which the statement refers.

Early Years Foundation Stage

- prime areas of communication and language, including understanding, speaking and listening and attention
- prime areas of physical development, including moving and handling
- prime areas of personal, social and emotional development, including making relationships, self-confidence and self-awareness and managing feelings and behaviour
- specific areas of understanding the world, including technology and the world
- specific areas of mathematics, including numbers and shape, space and measures

KS1: Science

Years 1 and 2: Working scientifically

- ask simple questions and recognise that they can be answered in different ways
- identify and classify
- use their observations and ideas to suggest answers to questions

Your booking – additional information

Storytelling with Puppets

Year 1: Animals, including humans

- describe and compare the structure of a variety of common animals (fish, amphibians, reptiles, birds and mammals, including pets)

Year 1: Everyday materials

Pupils should be taught to:

- identify and name a variety of everyday materials, including wood, plastic, glass, metal, water, and rock

Year 1: Plants

- identify and describe the basic structure of a variety of common flowering plants, including trees

Year 2: Living things and their habitats

- identify that most living things live in habitats to which they are suited and describe how different habitats provide for the basic needs of different kinds of animals and plants, and how they depend on each other
- identify and name a variety of plants and animals in their habitats, including microhabitats

Year 2: Plants

- observe and describe how seeds and bulbs grow into mature plants
- find out and describe how plants need water, light and a suitable temperature to grow

KS1 and KS2: English

Spoken language

- listen and respond appropriately to adults and their peers
- ask relevant questions to extend their understanding and knowledge
- articulate and justify answers, arguments and opinions
- maintain attention and participate actively in collaborative conversations, staying on topic and initiating and responding to comments
- use spoken language to develop understanding through speculating, hypothesising, imagining and exploring ideas
- speak audibly and fluently with an increasing command of Standard English
- gain, maintain and monitor the interest of the listener(s)
- consider and evaluate different viewpoints, attending to and building on the contributions of others